

Series C Gearboxes : Dimensions motorised

Shaft Mounted Motorised - with flange Double/Triple Reduction

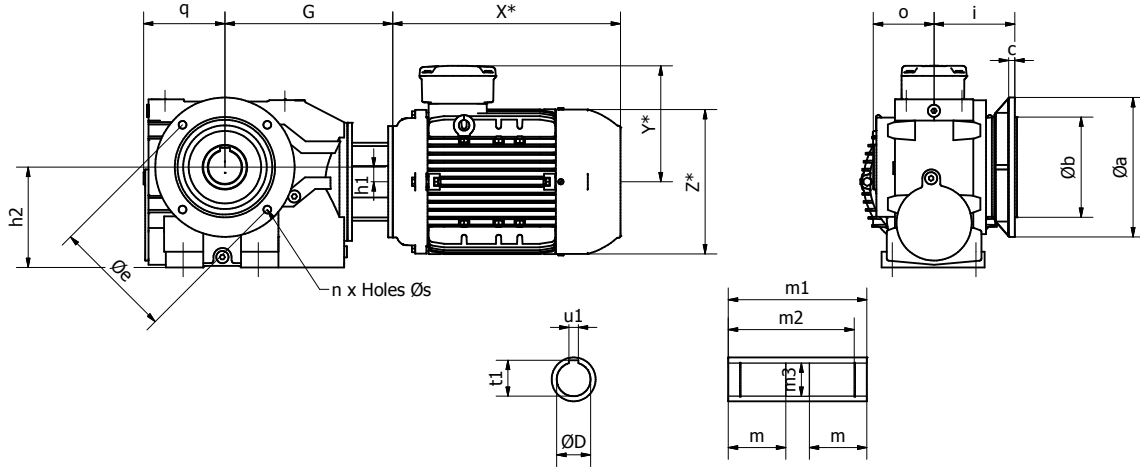

Unit Size	Flange Dimensions							h2	h1	q	o	i	Shaft Dimensions						
	Øa	Øb	c	Øe	n	Øs	D						m1	t1	u1	m	m2	m3	Shaft Fixing Bolt
874	250	180 j6	12	215	4	14	180	26	143	109	145	Ø50 H7 *	76	48.5	14	3	70	70	M16 x 2.0 x 36 deep
												Ø60 H7	76	48.5	14	3	70	70	M16 x 2.0 x 36 deep
875	350	250 h6	18	300	4	18	225	28	168	125	170	Ø60 H7 *	120	64.0	18	3	110	110	M12 x 1.75 x 28 deep
												Ø70 H7	120	64.0	18	3	110	110	M12 x 1.75 x 28 deep
876	450	350 h6	20	400	8	18	280	40	195	150	200	Ø70 H7 *	135	74.5	20	3	125	125	M16 x 2.0 x 36 deep
												Ø90 H7	135	74.5	20	3	125	125	M16 x 2.0 x 36 deep
877	450	350 h6	22	400	8	18	335	65	235	175	232	Ø80 H7 *	170	95.0	25	3	160	160	M16 x 2.0 x 36 deep
												Ø100 H7	170	95.0	25	3	160	160	M16 x 2.0 x 36 deep

G Dimension/weight - excluding motor

Unit Size		Motor Frame Size										
		63	71	80	90	100	112	132	160	180	200	225
874 Double	G	-	-	257	267	279	279	301	309	-	-	-
	kg	-	-	78	79	81	81	83	88	-	-	-
874 Triple	G	308	314	332	342	369	369	369	-	-	-	
	kg	88	88	88	88	90	90	90	-	-	-	
875	G	-	-	337	337	343	343	343	373	-	-	
	kg	-	-	130	130	132	132	135	152	-	-	
876	G	-	-	358	358	364	364	364	399	399	399	
	kg	-	-	212	212	214	214	217	222	235	239	
877	G	-	-	-	-	402	402	402	437	437	437	
	kg	-	-	-	-	343	343	346	351	364	368	

Flange and Shaft

Unit Size	Part No	
874	Output Flange	874A9900
	Extended Shaft	874A9790
875	Output Flange	875A9900
	Extended Shaft	875A9790
876	Output Flange	876A9900
	Extended Shaft	876A9790
877	Output Flange	877A9900
	Extended Shaft	877A9790

All weights are approximate and exclude lubricant and packing
* For Motor weight and dimensions X,Y and Z - please refer to motor tables on page 314

Handing

